

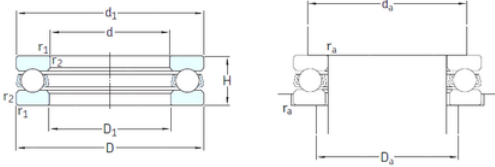

# Cixi Kent Bearing Co., Ltd.



## SKF 51108 Thrust Ball Bearing 51105, 51106, 51107, 51109, 51110

Bearing No. 51108

51108 Bearing 2D drawings and 3D CAD models

Size	40x60x13 mm
Bore Diameter	40 mm
Outer Diameter	60 mm
Width	13 mm
d	40 mm
D	60 mm
H	13 mm
d1	60 mm
r1 min.	0,6 mm
r2 min.	0,6 mm
D1	42 mm
da min.	52 mm
Da max.	48 mm
ra max.	0,6 mm
Weight	0,12 Kg
Basic dynamic load rating (C)	25,5 kN
Basic static load rating (C0)	63 kN
Fatigue load limit (Pu)	2,32
Reference speed	5000 r/min
Limiting speed	7000 r/min
Category	Thrust Ball Bearing
Inventory	0.0
Manufacturer Name	SKF
Minimum Buy Quantity	N/A
Weight / Kilogram	0.128



## Cixi Kent Bearing Co., Ltd.

EAN	7316577058614
Product Group	B00308
Rolling Element	Ball Bearing
Thrust Bearing	Yes
Single or Double Direction	Single Direction
Banded	No
Cage Material	Steel
Precision Class	ABEC 1   ISO P0
Component Description	Roller Assembly Plus Raceways
Other Features	Single Row
Long Description	40MM Bore 1; 42MM Bore 2; 60MM Outside Diameter; 13MM Height; Ball Bearing; Single Direction; Not Banded; Steel Cage; ABEC 1   ISO P0 Precision
Inch - Metric	Metric
Category	Thrust Ball Bearings
UNSPSC	31171507
Harmonized Tariff Code	8482.10.50.08
Noun	Bearing
Keyword String	Ball Thrust
Manufacturer URL	<a href="http://www.skf.com">http://www.skf.com</a>
Manufacturer Item Number	51108
Weight / LBS	0.283
Height	0.512 Inch   13 Millimeter
Bore 2	1.654 Inch   42 Millimeter
Overall Height with Aligning Washer	0 Inch   0 Millimeter
Bore 1	1.575 Inch   40 Millimeter
Outside Diameter	2.362 Inch   60 Millimeter
bore diameter:	40 mm
static load capacity:	63 kN



## Cixi Kent Bearing Co., Ltd.

outside diameter:	60 mm
dynamic load capacity:	25.5 kN
overall width:	13 mm
maximum rpm:	7000 RPM
thrust bearing type:	Single-Direction
cage material:	Steel
outside diameter design:	Straight
fillet radius:	0.6 mm
separable or banded:	Separable
series:	511
precision rating:	ABEC 1 (ISO Class Normal)
$d_1$	60 mm
$D_1$	42 mm
$r_{1,2}$ min.	0.6 mm
$d_a$ min.	52 mm
$D_a$ max.	48 mm
$r_a$ max.	0.6 mm
Basic dynamic load rating C	25.5 kN
Basic static load rating $C_0$	63 kN
Fatigue load limit $P_u$	2.32 kN
Minimum load factor A	0.02
Mass bearing (including seat washer where applicable)	0.12 kg